



STEP 2: CHOOSE YOUR TENT

BASECAMP



Optional ensuite & tropical roof shown



Tent Set Up 3 minutes
Awning Set Up 8 minutes

'The true home away from home'

A true, tried and tested model in our range. This tent is the result of decades of testing and has evolved through constant improvements in both options and finish. Our new range features a completely free standing tent with all poles permanently attached in the main structure, even standing on its own without guy ropes. Simply open the camper up, step inside and extend the internal pole system in the tent and you're done.

This tent is so versatile it can be set up in a matter of minutes for a comfortable one night getaway, a weekend with the family or extended stays at your favourite camp. With an extensive list of standard features and options to adapt the tent perfectly to your needs, it will be sure to tick all the boxes.

Specs

- Australian Wax Converters Dynaproofed canvas
- 10' x 7' (Safari) 10' x 9' (Safari Extenda) floor area
- 8' zip on awning with gable front & wall provisions
- Exclusive awning design eliminates water pooling without using additional poles
- Kitchen wall with large window
- 6 large full length windows with canvas flaps on inside
- 2 x lower wall vents to maximise airflow
- Zip access to mudguard box
- Unique zip gutter design provides excellent water ingress protection
- Bucket style zip in floor
- Easy internal pole system for setup in under 3 minutes
- Fully sealed tonneau with 6 adjustable pulldown straps to minimise flapping & dust/water ingress
- Quality poles, pegs & ropes needed for complete set up
- All stainless-steel fittings on tent
- Magazine pocket on wall

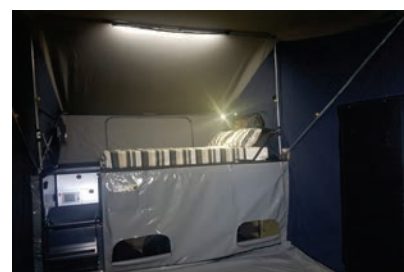
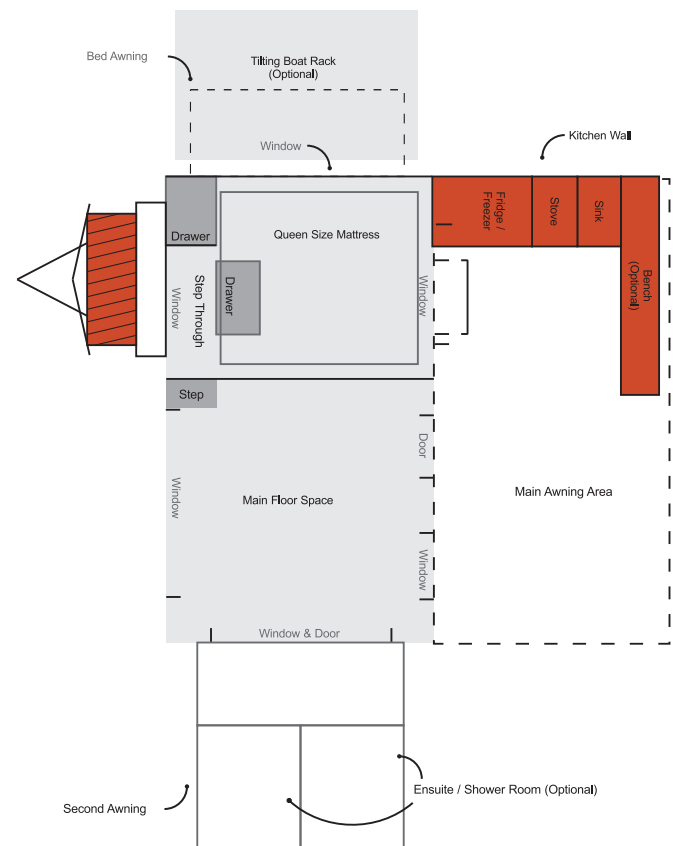

Scan here
for more information